

Installation and Operating Instructions

BATH FAN / LED LIGHT

READ AND SAVE THESE INSTRUCTIONS

GENERAL SAFETY INFORMATION

1. Make sure that the electric service supply voltage is AC 120V, 60Hz.
2. Follow all local electrical and safety codes, as well as the National Electrical Code (NEC) and the Occupational Safety and Health Act (OSH Act).
3. Always disconnect the power source before working on or near the ventilating fan, motor or junction box.
4. Protect the power cord from sharp edges, oil, grease, hot surfaces, chemicals or other objects.
5. Do not kink the power cord.
6. Do not install the unit where ducts are configured. (Fig. A).
7. Provide suction parts with proper ventilation.
8. This unit is UL Listed for use over a bathtub or shower when installed in a GFCI protected branch circuit.

WARNING

TO REDUCE THE RISK OF FIRE, ELECTRIC SHOCK, OR INJURY TO PERSONS, OBSERVE THE FOLLOWING:

1. Use this unit only in the manner intended by the manufacturer. If you have questions, contact the manufacturer.
2. Before servicing or cleaning unit, switch power off at the service panel and lock the service disconnecting means to prevent the power from being switched on accidentally. When the service disconnecting means cannot be locked, securely fasten a prominent warning device, such as a tag, to the service panel.
3. Installation work and electrical wiring must be done by a qualified person(s) in accordance with all applicable codes and standards, including fire-rated construction.
4. Sufficient air is needed for proper combustion and exhausting of gases through the flue (chimney) of fuel burning equipment to prevent backdrafting. Follow the heating equipment manufacturer's guideline and safety standards such as those published by the National Fire Protection Association (NFPA), and the American Society of Heating, Refrigerating and Air-Conditioning Engineers (ASHRAE) and local code authorities.
5. When cutting or drilling into the wall or ceiling, do not damage electrical wiring and other hidden utilities.
6. Ducted fans must always be vented to the outdoors.
7. If this unit is to be installed over a tub or shower, it must be marked as appropriate for the application and be connected to a GFCI (Ground Fault Circuit Interrupter) –protected branch circuit.
8. Do not use this unit with any other solid-state control device. Solid-state control device may cause harmonic distortion, which can cause a motor humming noise. (Avertissement: ne convient pas à des régulateurs de vitesse à semi-conducteurs).
9. NEVER place a switch where it can be reached from a tub or shower.
10. Not to be installed in a ceiling thermally insulated to a value greater than R50. (This is required for installation in Canada only).
11. Do not open/disassemble the LED light engine

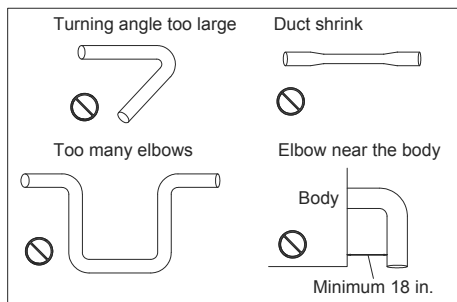

Fig. A

CAUTION

1. For General Ventilating Use Only. Do Not Use To Exhaust Hazardous Or Explosive Materials And Vapors.
2. Not for use in cooking areas. (Fig. B)
3. This product must properly connect to the grounding conductor of the supply circuit.

4. To reduce the risk of injury to persons, install the fan at least 8.2 feet (2.5m) above the floor.

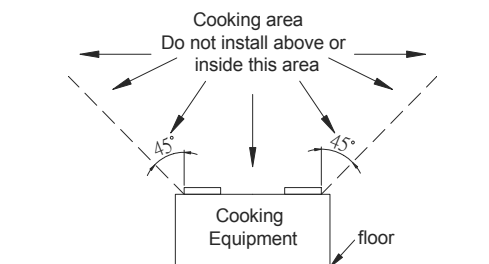

Fig. B

PREPARATION

Tools Required for Assembly (not included): Hammer, Flathead Screwdriver, Wire Nuts, Nails, Duct Tape, Phillips Head Screwdriver, and Utility Knife.

Helpful Tools (not included): Electric Drill, Drill Bits.

WARNING: Turn off electricity at breaker box before beginning installation.

- o Carefully remove unit from carton.
- o Check area above installation location to be sure that wiring can run to the planned location and that duct work can be run. Make sure the area is sufficient for proper ventilation.
- o Inspect duct work and wiring before proceeding with installation.
- o Before installation, provide inspection and future maintenance access at a location that will not interfere with installation work.
- o You may need the help of a second person to install this fan: one person on the attic side and one on the room side.

Note: Installations may vary depending on how the previous bath fan was installed. Supplies necessary for the installation of your bath fan are not all included. However, most are available at your local home improvement or hardware store.

DIMENSION REQUIREMENTS

Housing Dimension (L)	Housing Dimension (W)	Housing Dimension (H)
8"	8 1/4"	5 3/4"

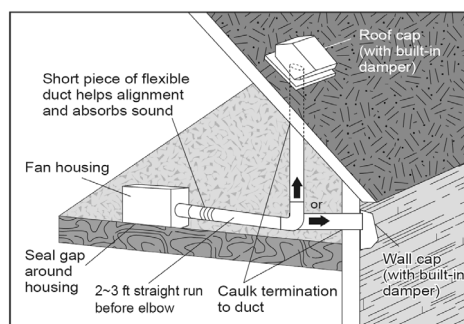

Proper insulation around the fan to minimize building heat loss and gain. The ducting from this fan to the outside of the building has a strong effect on the air flow, noise and energy use of the fan. Use the shortest, straightest duct routing possible for best performance, and avoid installing the fan with smaller ducts than recommended. Insulation around the ducts can reduce energy loss and inhibit mold growth. Fans installed with existing ducts may not achieve their rated air flow.

- o The fan will operate most efficiently when located where the shortest possible duct run and minimum number of elbows will be needed.
- o Locate unit above (GFCI-protected circuit required) or within 5 feet of the shower head.
- o Use a roof cap or wall cap that has a built-in damper to reduce backdrafts.
- o External timer can be used in conjunction with single-speed mode only, please contact Delta Breez customer service and consult with a licensed electrician for compatibility.

- o External dimmer can be used in conjunction with LED light model, please contact Delta Breez customer service and consult with a licensed electrician for compatibility.

PACKAGE CONTENTS

PART	DESCRIPTION	QTY
①	Fan Body	1
②	LED Module	1
③	Regular Rod (3 13/16")	1
④	Longer Rod (4 1/2")	1
⑤	Gasket	1
⑥	Glass Shade	1
⑦	Plastic Nut	1
⑧	Decorative Caps and Finial nuts: chrome, brushed nickel, brushed bronze and polish white	4 sets
⑨	HARDWARE CONTENTS	1

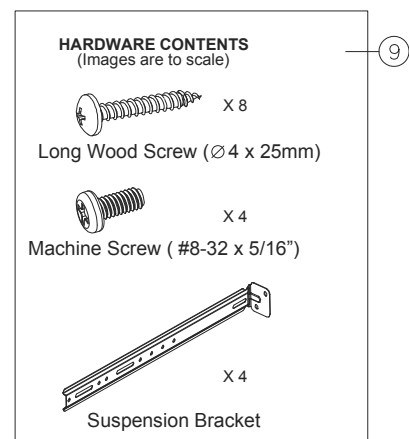
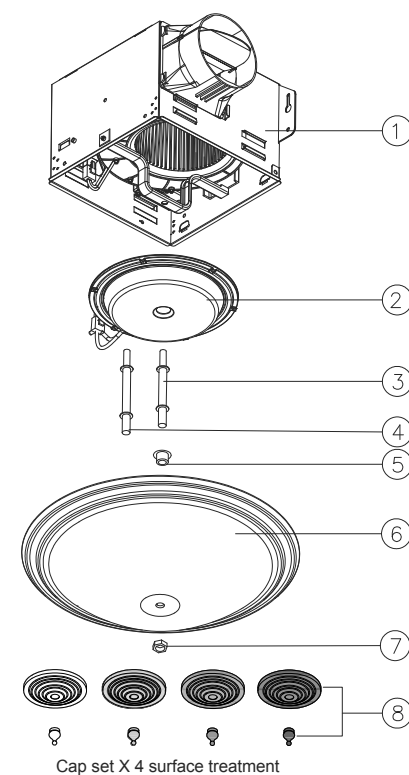

ASSEMBLY INSTRUCTION

BEFORE INSTALLATION

Turn off power source. Review all safety precautions.

NEW CONSTRUCTION

MOUNT HOUSING WITH FLANGE:

1. To bend the housing tabs out to 90 degrees and make housing tabs contact the bottom of the joist.

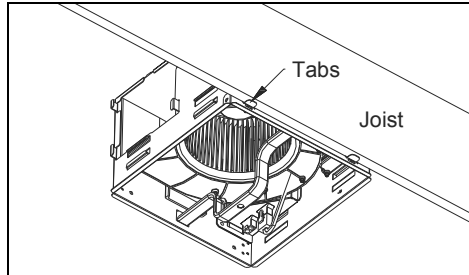

2. The housing mounts with 4 long screws (ø 4x25mm). Screw housing to joist through lowest holes in each mounting flange, then through the other holes.

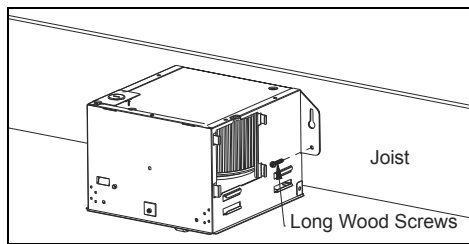

USING SUSPENSION BRACKETS

1. Sliding suspension brackets available to allow for your specific positioning of housing anywhere between joists and span up to 24".

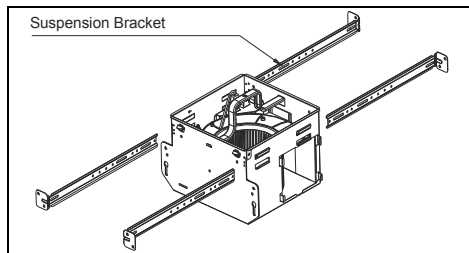

2.
 - A. Extend suspension brackets to the width of the joists. Make sure the fan body is level and perpendicular with the joist, and flush with ceiling surface.
 - B. Fasten suspension brackets to joists with long wood screws.
 - C. Secure suspension brackets together with machine screws.

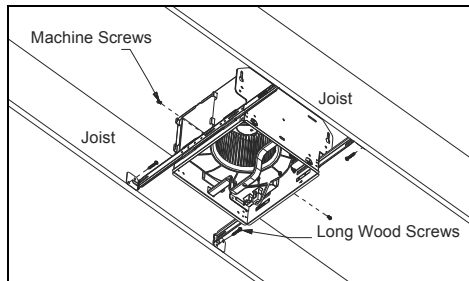

EXISTING CONSTRUCTION – ACCESSIBLE FROM ABOVE

1. Remove existing fan. Measure the ceiling opening to ensure it is large enough to accommodate the new fan (8" x 8 1/4").

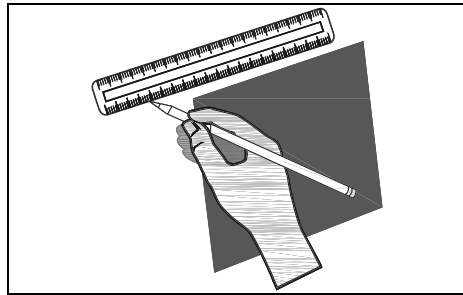

2. If this fan is not replacing an existing fan, be sure to cut an 8" x 8 1/4" opening for the fan body.

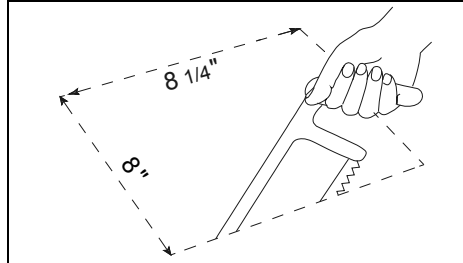

3. Place housing in opening so that its bottom edge is flush with finished ceiling. Secure housing to joist through lowest holes in each mounting flange.

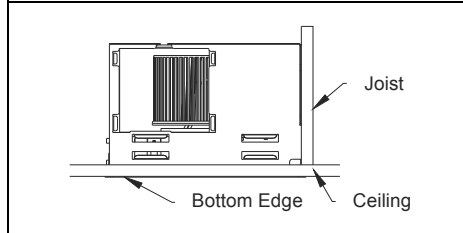
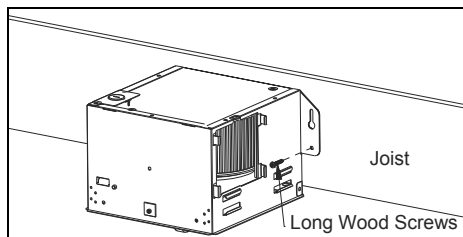

4. Insert the duct (not provided) into the duct connector and tape all ductwork connection to make them secure and air tight. Install the duct with a gradient 1"~2" to the outside.

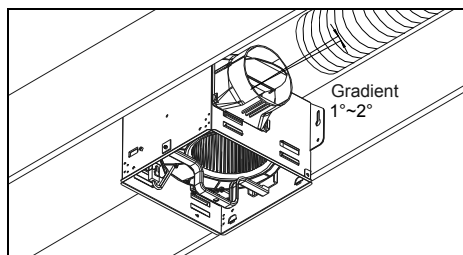

CONNECT WIRING

TURN OFF POWER SOURCE.
REVIEW ALL SAFETY PRECAUTION.

1. Follow all local electrical and safety codes, ANSI/NFPA70.
2. NEVER place a switch where it can be reached from a tub or shower.
3. Remove the fan junction box cover. Using wire nuts (not supplied) connect house wires to fan wires as shown in the wiring diagram. Wire connections are as follows: black and red to live switch wire, white to neutral, green to ground. Reattach fan junction box cover.

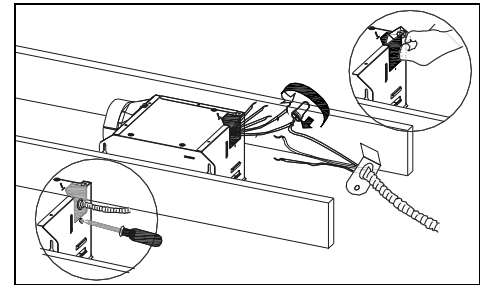

4. 14 AWG (2.1 mm²) is the smallest conductor that shall be used for branch-circuit wiring.

CONVENTIONAL WIRING DIAGRAM

Turn POWER/LIGHT switch on to operate the fan/LED light on.

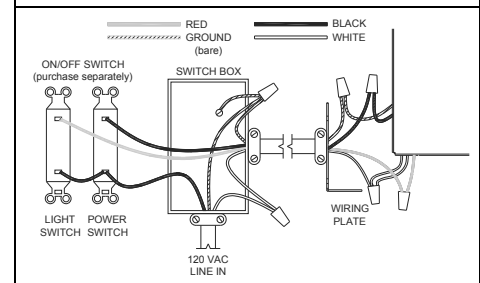
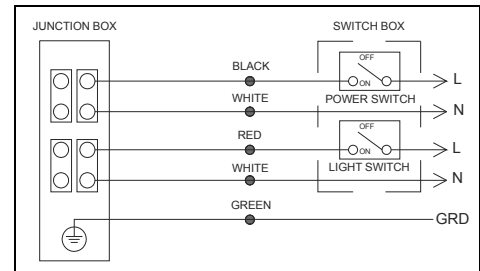

OTHER WIRING OPTION

Combine power & light to one switch, fan and light will ON/OFF at the same time.

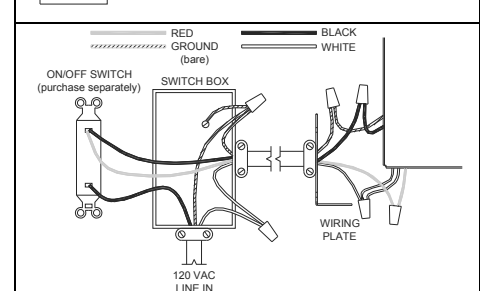
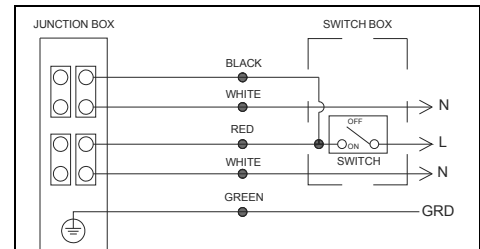

GLASS SHADE INSTALLATION

1. Insert the LED lighting connector into the LED socket.

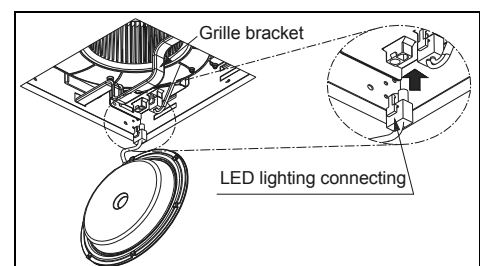

2. Insert the regular rod through center hole of LED module and screw into the bracket.

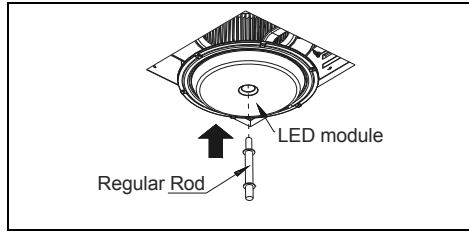

3. Place glass shade over mounting rod. Secure glass shade with gasket, plastic nut, cap and finial nut.

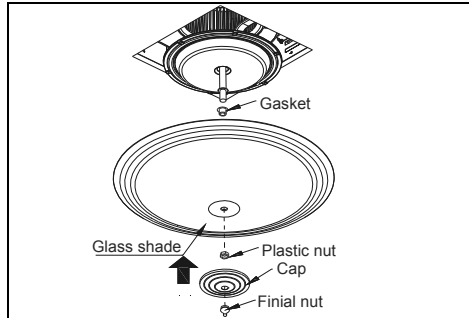

4. Make sure the gap between Glass shade and ceiling is more than 1/4". If the gap is below 1/4", change the regular rod to longer rod. Reinstall glass shade by step 3.

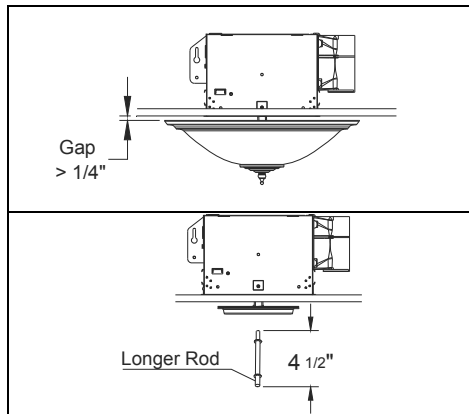

CARE AND MAINTENANCE

TURN OFF POWER SOURCE. REVIEW ALL SAFETY PRECAUTION.

See safety information before proceeding. Routine maintenance should be done at least once a year.

CAUTION:

- Never use gasoline, benzene, thinner or any other such chemicals to clean the ventilating fan.
- Do not allow water to enter the motor.
- Do not immerse metal parts in water.
- Do not soak resin parts in water over 140°F (60°C).

CLEANING:

Carefully unscrew plastic nut, cap, finial nut and rod to remove glass shade and LED module.

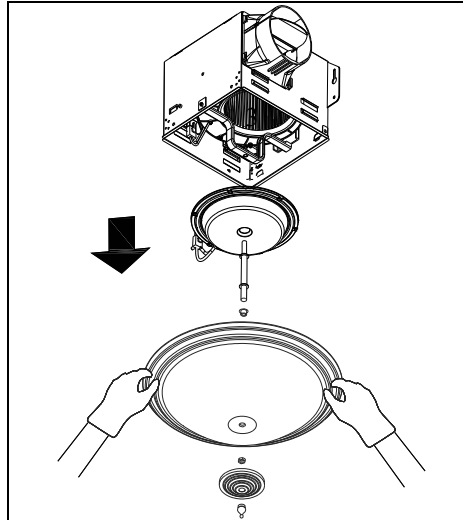

1. Wash and clean the glass shade, and clean the LED module with a cloth.

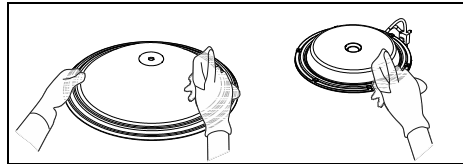

2. Remove dust and dirt from the fan body with a vacuum cleaner.

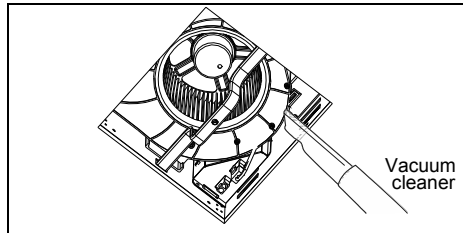

3. Dampen cloth with dust detergent and wipe the fan body. Then wipe dry with a clean cloth.

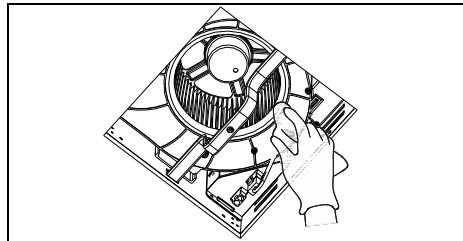

4. Replace glass shade back onto fan body. Turn on power source to operate fan again.

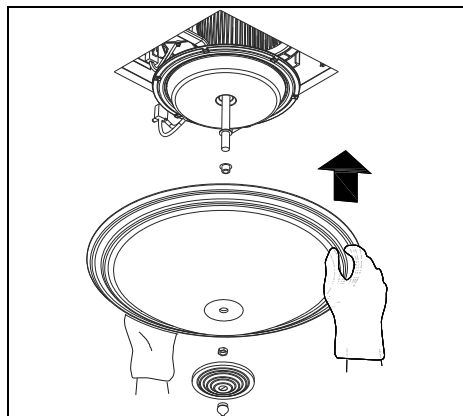

DIMENSIONS

Unit: Inch

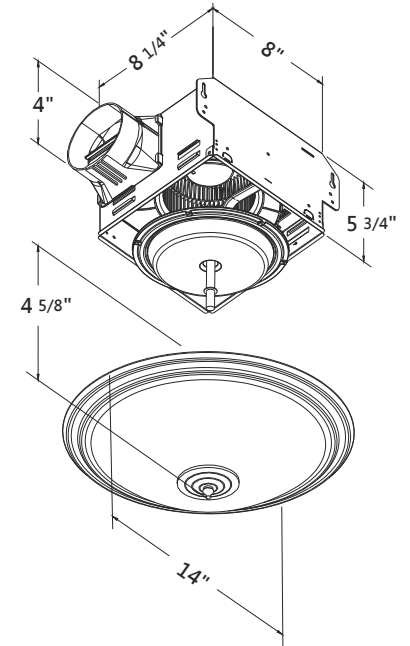

WARRANTY

DELTA ELECTRONICS THREE YEAR LIMITED WARRANTY

Delta Electronics Inc. ("Delta Electronics") warrants to the original consumer purchaser in the USA and Canada that the Breez ventilation fan products will be free from defects in material or workmanship. This warranty is limited to three (3) years from the original date of purchase.

Limitations and Exclusions

1. During the warranty period, a replacement for any defective product will be supplied free of charge for installation by the consumer. The warranty provided herein does not cover charges for labor or other costs incurred in the troubleshooting, repair, removal, and installation service.
2. All returns of defective parts or products must include the product model number, and must be made through an authorized Delta Electronics distributor. Authorized returns must be shipped prepaid. Repaired or replacement products will be shipped by Delta Electronics F.O.B. shipping point.
3. Delta Electronics shall not be liable for any indirect, incidental, consequential, punitive, or special damages arising out of or in connection with products use or performance, regardless of the form of action whether in contract, tort (including negligence), strict product liability or otherwise.
4. The warranty does not cover if user does not comply with manufacturer's installation manual.
5. To qualify for warranty service, you must notify Delta Electronics at the address or telephone number below.
6. Delta Electronics shall have no liability to the original owner-user with respect to any defect caused by abuse, misuse, neglect, improper transportation or storage, improper testing, improper installation, improper operation, improper use, improper maintenance, improper repair, improper alteration, improper modification, tampering or accident of products or parts thereof, or unusual deterioration or degradation of products or parts thereof due to a physical environment beyond the requirements of products' specifications.

Address: 46101 Fremont Boulevard, Fremont, CA 94538
US Toll Free Number:
1-888-979-9889 - Technical Support
1-877-685-4384 - Customer Sales Support
www.deltabreez.com

TROUBLE SHOOTING

PROBLEM	POSSIBLE CAUSE	CORRECTIVE ACTION
The fan is not turning on	1. Power off 2. Faulty switch 3. Faulty wire connection	1. Make sure power supply is on. 2. Test or replace switch. 3. Check wire in switch box.
The fan seems louder than it should	1. CFM too great 2. Damper not working properly or damaged 3. Bend in duct too close to fan discharge 4. Fan discharge reduced to fit smaller duct 5. Fan body not securely attached	1. Be sure the CFM rating on the fan matches the size of your room. 2. Check damper to ensure it is opening and closing properly. If the damper has become damaged, please call Customer Service. 3. Be sure you do not have any sharp bends in duct closer than 18" to the fan discharge. 4. Use recommended size ducting to reduce fan noise. 5. Be sure the fan is securely attached to your ceiling joists.
The fan is not clearing the room	1. Insufficient intake airflow within room 2. Insufficient CFM	1. Be sure a door or window is slightly ajar or opened to allow airflow. The fan is not able to draw air out of the room without enough airflow to draw in from. 2. Be sure the CFM rating on the fan matches the requirements for your room size.
The light is not turning ON	1. Power off 2. Faulty switch 3. Faulty wire connection	1. Make sure power supply is on. 2. Test or replace switch. 3. Check wire in switch box.

SPECIFICATIONS

Model No.	Voltage (V)	Frequency (Hz)	Air Flow @ 0.1"SP (CFM)	Power @ 0.1"SP (W)	Noise @0.1"SP (Sones)	Weight (lb.)	Light Spec
GBR100LED-DECOR	120	60	100	13.0	1.5	9.6	13 Watts, 950 Lumens, 3000K

Note: Specifications subject to change without notice.

